

# HOUSE OF HOPE ARENA TECHNICAL SPECIFICATIONS

## Arena Dimensions

Stage: 100'W x 49'-4"D +7'-5"D X 14'-5" (Thrust)

- Arena Floor: 234' -6"W x 130' -5" (91' from Thrust edge to Technical Booth)
- Main concourse: 160,200 Sq./Ft. [234'-6"W X 130' -5"D]
- Upper concourse: 99,300 Sq./Ft.
- Ticket office: 3,000 Sq./Ft.

Arena site: A total property of 23 acres

Main Concourse: Terrazzo Floor

## Loading Docks

Loading Dock 1 [Stage Level Overhead Door w/Media Power]

Loading Dock 2 [Ground Level Overhead Door w/Media Power]

Loading Dock 3 [Ground Level Overhead Door w/Hydraulic Dock Plate]

## Parking (Off Site Parking available)

2,000 parking spots on site

120 disabled parking spots on site

Truck/Bus Parking: On-Site

## Rigging Grid

58,500 Capacity

1,500 Lb. maximum hanging dead load reaction from rigging beam to bar hoist W8x15 steel rigging beam w/4" wide flange +40'-2" from stage floor  
Catwalk has one access point only at east end, via. ships ladder

## Elevators

Two (2) Public 5,000 lb. traction elevators 3'-11.5"W X 9'D X 9'H

## Freight Elevator

Inside Dimensions: 6'-6"W X 4'-8"D X 8'H

Weight Capacity: 2,500 lbs.

## Electrical Power

Electrical closets located 50 feet adjacent to stage on east and west sides

- Total available show power capacity: 1,500 KVA (5,000 amps) at 208/120 volt, 3 phase, 4 wire via dedicated transformer substation, located at the event level electrical room
- Stage Right side: 800 amps (2 company switches/400 amps each) for various events. Company switch is an enclosed cabinet, specifically equipped for safe, reliable and quick portable power connections
- Total of 400 amps two switches. One located by Loading Docks 1 and 2 AV Truck Link 120/208V 304 wire
- Two (2) Shore Power locations available for touring buses. One (1) at loading Dock 2 and one (1) at an adjacent island in parking lot

## Dressing Rooms

Two (2) Auxiliary Locker Rooms located outside of talent corridor

- Auxiliary Locker Room w/Showers #1: 240 sq. ft.
- Auxiliary Locker Room w/Showers #2: 240 sq. ft.
- Two (2) Star Dressing Rooms (toilet/shower facilities) Equipped with TV Monitors and telephone.
- Dressing Room #1: 124 sq. ft.
- Dressing Room #2: 135 sq. ft.
- Dressing Room #3: 265 sq. ft.
- Two (2) Dividable Production/Catering Rooms equipped with sinks, 2 phone Lines and 2 data lines: 640 sq. ft.

## Production Office

640 sq. ft. Office located 50 ft. from rear of stage

## Laundry Facilities

239 sq. ft. Roadie Laundry, with industrial size washer and dryer, located outside talent corridor

## Lighting

ETC Net ARENA LIGHTING

ETC Net THEATRICAL LIGHTING [Lighting Plot and Inventory available upon request]

ETC Expression console with ETC Net

Five (5) Elation Platinum Spot 5R

Two (2) spotlight locations on upper concourse level

## Audio

95,000 watt 4-way EV X-Array Concert Sound System

Two (2) (L/R) Line Array hangs of (7) EV X-Array, consisting of:

Four (4) EV XLVS

Two (2) EV XLVT

One (1) EV X-FIL

**Center:**

Five (5) EV XSUB

**Front Fills:**

Two (2) EV Xi-1082

**Front Down Fill:**

One (1) EV Xi-1122 MH64

**House Side Fills:**

Two (2) EV Xi-1152A

**Delay Ring:**

Thirteen (13) EV Xi-1153

**Amplifiers:**

Crown CTS Series

**Recording/Playback:**

128 AVID Pro Tools channels

**Front of House:**

AVID VENUE PROFILE 96 INPUTS, 24 OUTPUTS

**Monitors:**

AVID VENUE PROFILE 80 INPUTS, 24 OUTPUTS

19,000 Watt Monitor System

Four (4) d&b audiotechnik M2 powered by

Two (2) d&b audiotechnik D12 amps

Eight (8) EAW SM159zi Floor Monitors

Eight (8) EAW SM129zi Floor Monitors

**Broadcast Audio:**

YAMAHA PM1D Digital Mixing Console

Various outboard processing: Avalon, Lexicon and dbx

Digital Audio Recorder: iMac, Tracks Live 1.3 software

M-Audio interface

## Scoreboard

DAKTRONICS Scoreboard/Controller, stage rigged

## Video Production

Five (5) Sony D-50 Cameras

One (1) 40' Triangle Jimmy Jib

360 Clips Systems 3 Channel playback

One (1) Digital Video Recorder: iMac, Blackmagic Ultra Studio 4K interface. Media Express Software, Final Cut Pro X

One (1) Graphics Generator: iMac, ProPresenter 6 software

One (1) GrassValley Kayak 3ME Switcher

Internet Streaming Encoder

DVC-Pro Record Decks, Pioneer PRV-LX1 DVD Record Decks

Television broadcasting interface through 4 fiber optic circuits to SBC distribution

Two (2) PT-RW930LWU DLP Projector 10,000L WXGA (HL/HR)

Two (2) Panasonic ET DLE085 11.8 mm – 14.6 mm Zoom Lens

Two (2) 20' x 17 16:9 Screens (HL/HR)

One (1) QST 6MM 30' x 19' LED Video Wall (USC) 1536 X 864

## Safety

Arena Management has an emergency evacuation plan

## First Aid

First Aid Room located on Main Concourse at Gate 3

## Ticket Office

Two (2) Ticket Office windows between Gate 2 and Gate 3 for advance ticket sales during event

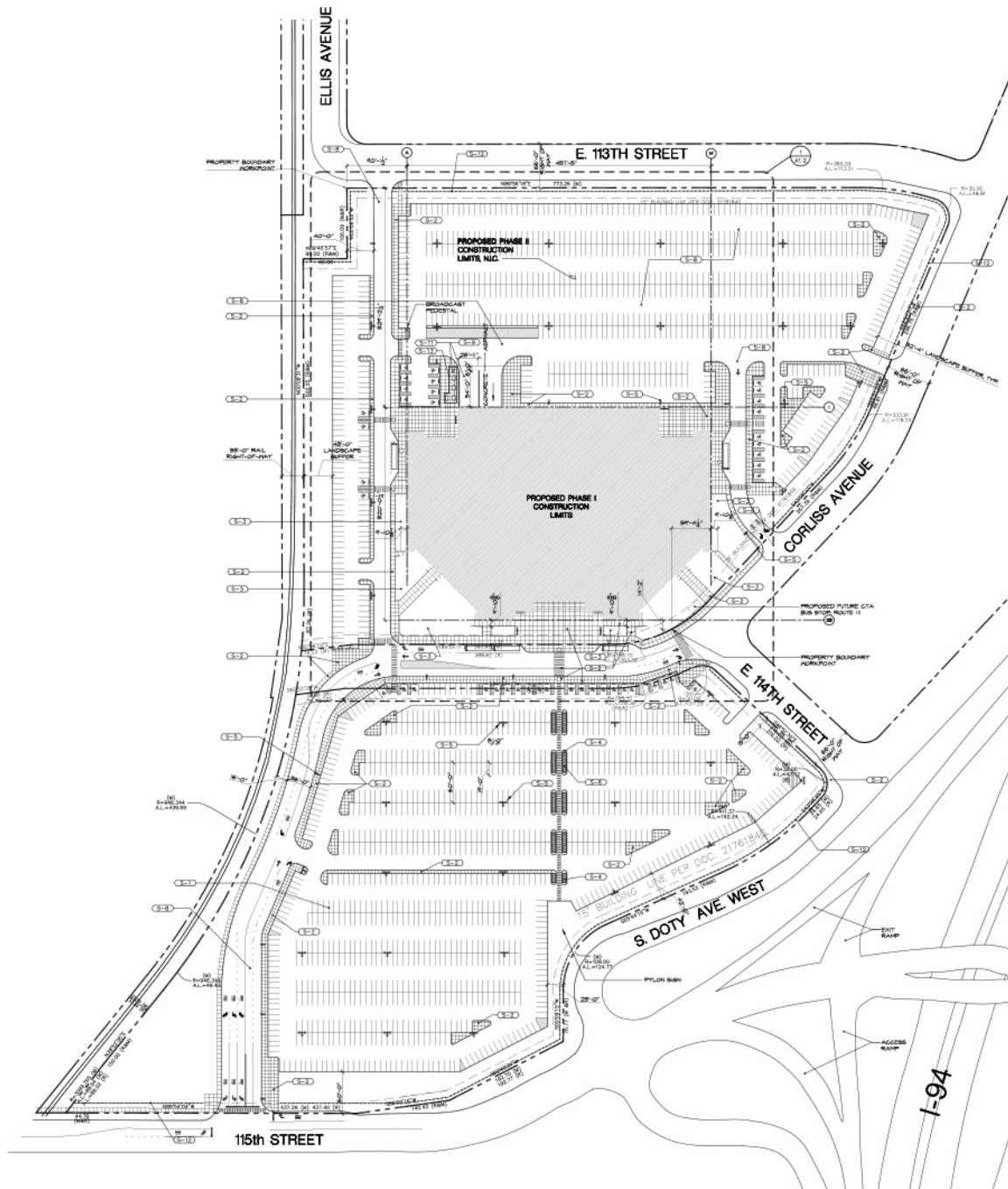

TOTAL BUILDING AREA: 202,889 S.F.

PARKING SPACES PROVIDED: 1883 SPACES  
42 ACCESSIBLE  
TOTAL PARKING: 1925 SPACES

1 ARCHITECTURAL SITE PLAN  
SCALE: 1/8" = 1'-0"

SEE SHEET A0.3 FOR PLAN KEY NOTES.

PROJECT DATUM: (+) 100'-0" = 11.0' C.C.D.

Proj. Mgr. **JM**  
Sht. Chg. **DE**  
Drawn by **SAKITM**  
Rev'd by **JM**  
Current Date: 05/12/04  
Iss. Date: 05/12/04

ISSUED FOR BUILDING PERMIT	04/12/04
ISSUED FOR BIDDING	05/12/04
PLANNING PARTY & APPLICATION	05/04/03
ISSUED FOR PRELIMINARY	05/05/03
AND SUPERSTRUCTURE POINT	05/16/03
ISSUED FOR DEC.	05/17/03
ISSUED FOR SFP	05/18/03
ISSUED FOR PRECAST SB	05/20/03
ISSUED FOR SCHEMATIC	05/20/03
ISSUED FOR SCHEMATIC	07/08/02
ISSUED FOR SCHEMATIC	07/08/02
DESCRIPTION	DATE

**ARCHIDEAS**  
Architecture  
Interior  
271 N. Superior Suite 410  
Chicago, Illinois 60610  
Telephone 312.581.1108  
Fax 312.581.0442  
E-mail: info@archideas.com

782 EAST 114th STREET  
CHICAGO, ILLINOIS

ARCHITECTURAL  
SITE PLAN

04/12/04 200/000

A11

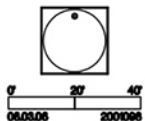
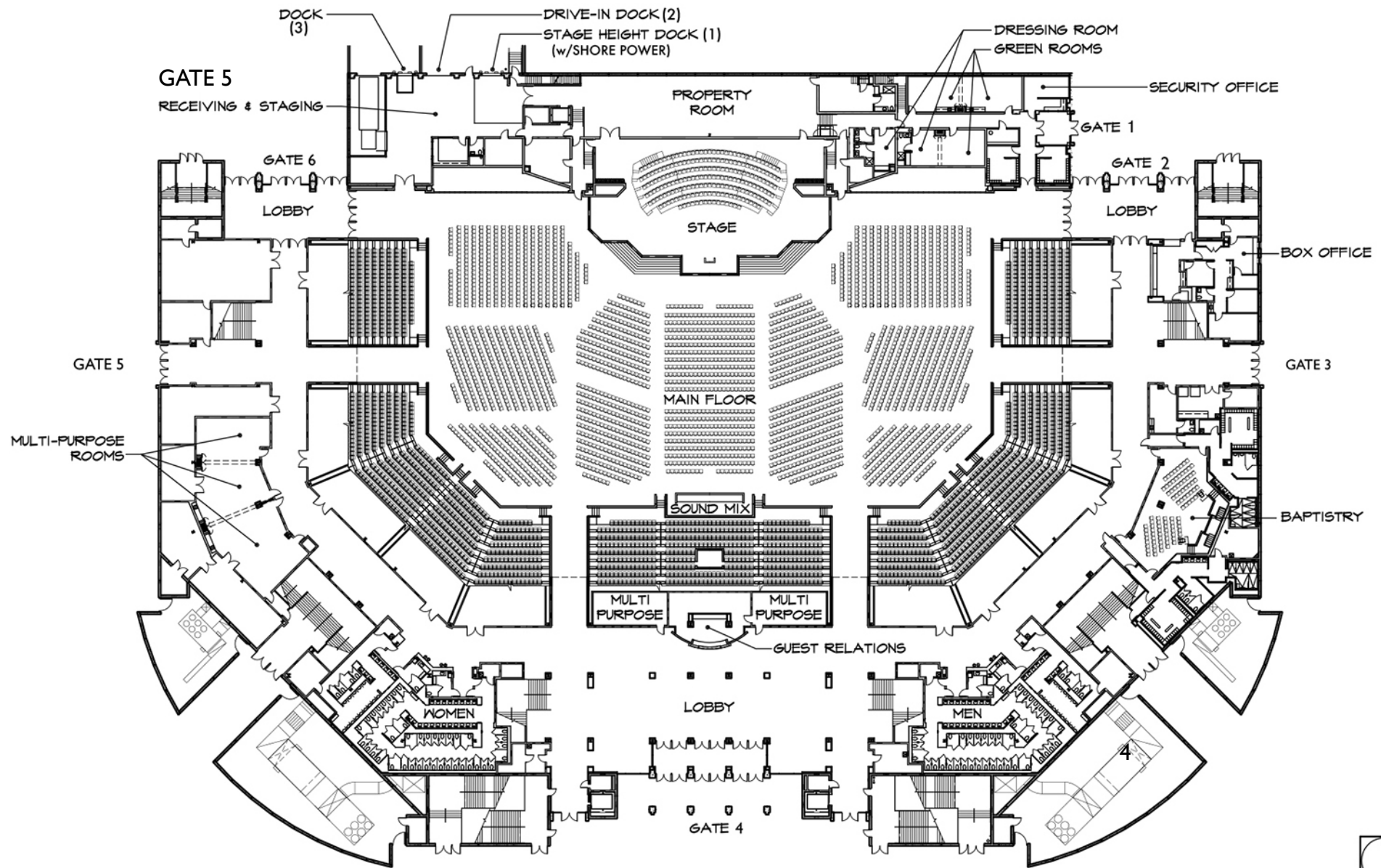

HOUSE OF HOPE  
 752 EAST 114TH STREET CHICAGO, ILLINOIS

OVERALL BUILDING PLAN

ARCHIDEAS

Architecture  
 Interiors  
 Planning

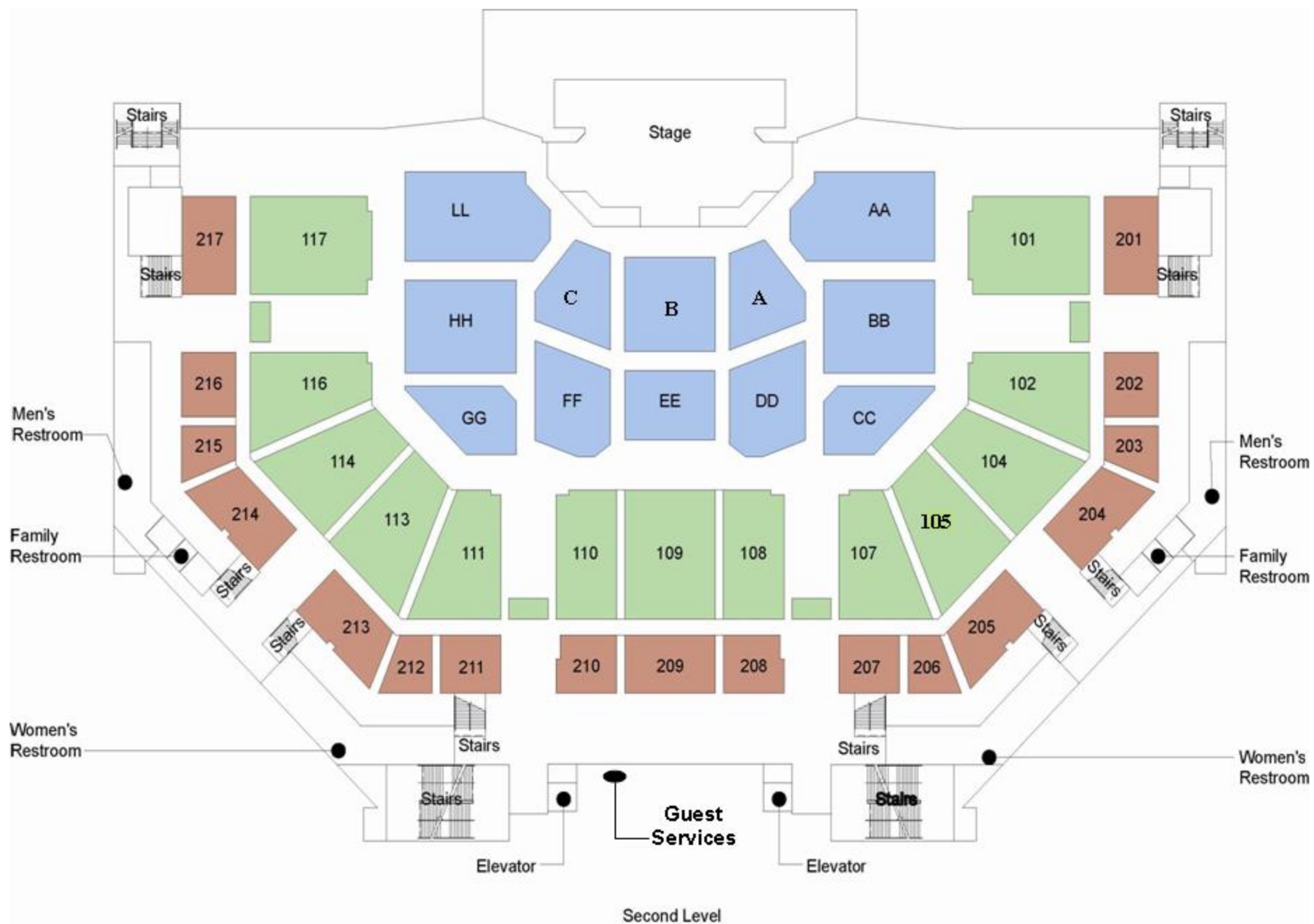

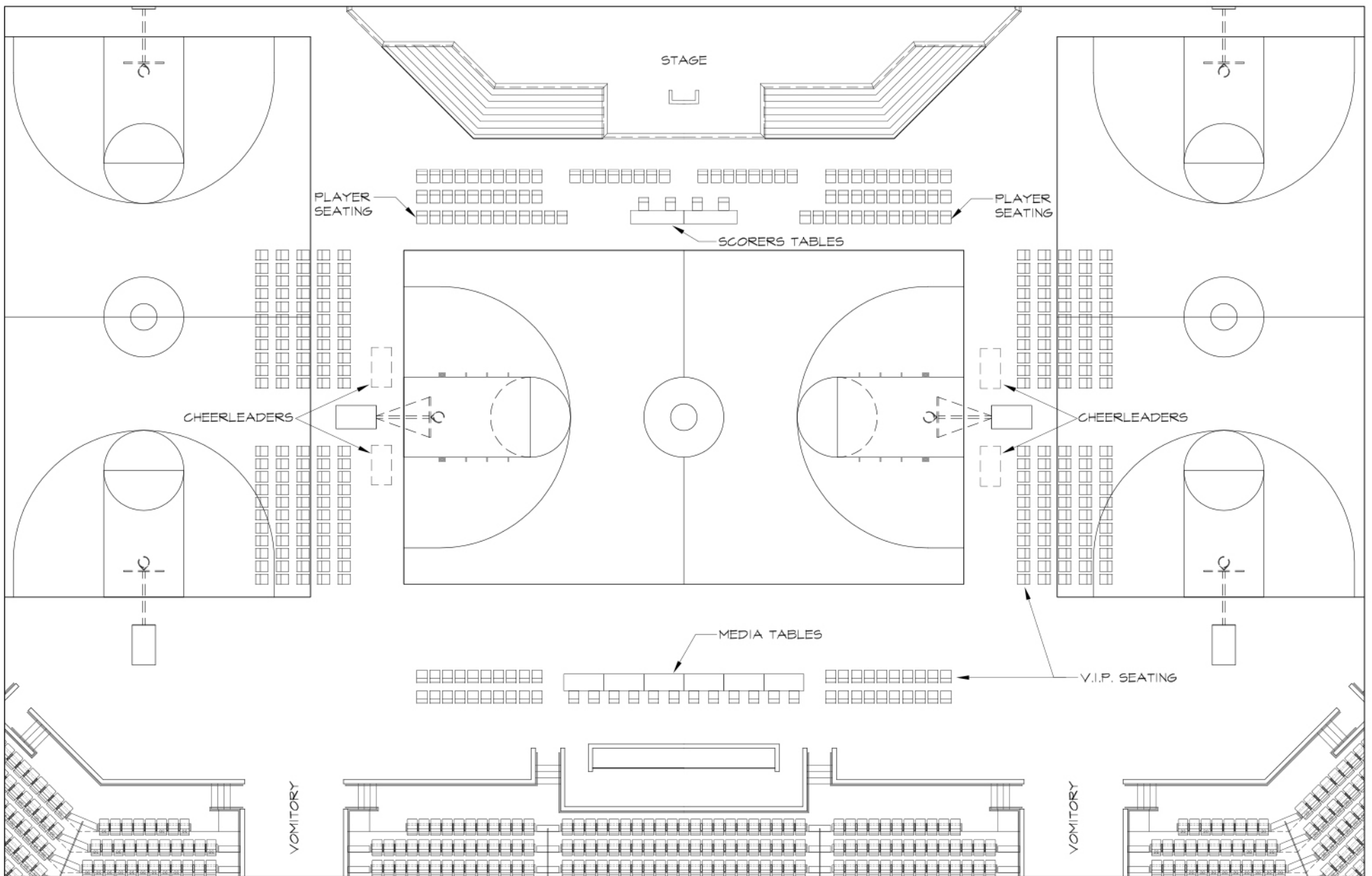

HOUSE OF HOPE  
752 EAST 114TH STREET CHICAGO, ILLINOIS

CENTER BASKETBALL COURT LAYOUT

ARCHIDEAS

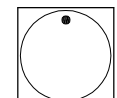
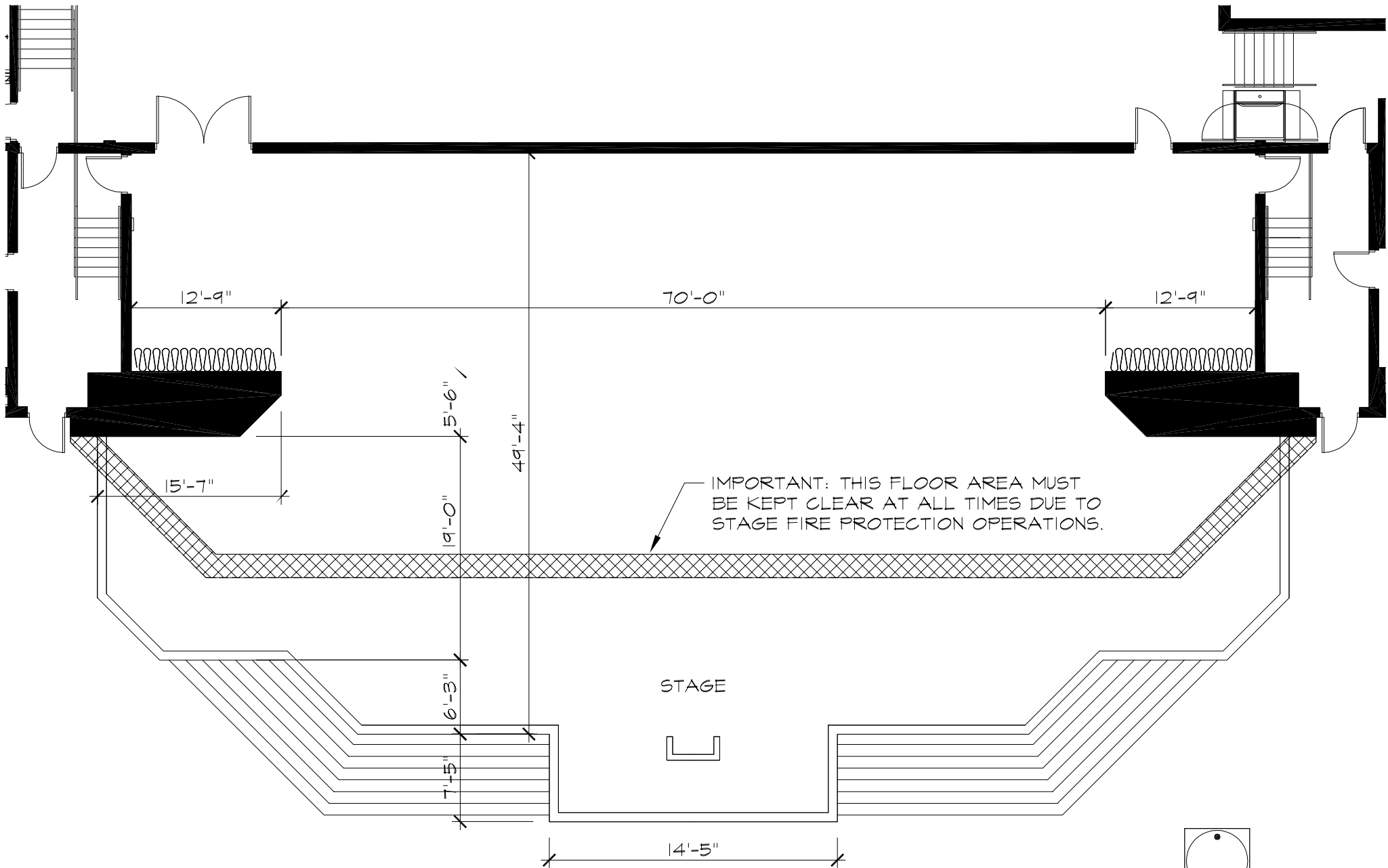

SCALE NTS

09.29.05

HOUSE OF HOPE  
752 EAST 114TH STREET CHICAGO, ILLINOIS

STAGE LAYOUT

ARCHIDEAS

Architecture  
Interiors  
Planning